

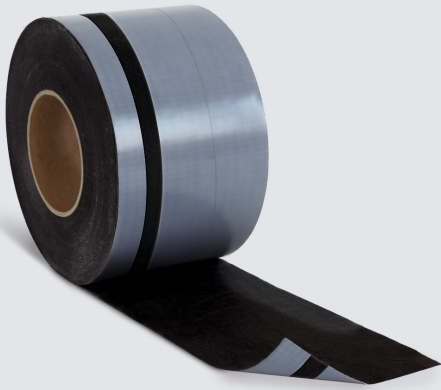

ISO
CHEMIE

45
YEARS
PRODUCTION

NEXT GENERATION BUILDING SEALING SOLUTIONS FOR TIGHT JOINTS



ISO-CONNECT VARIOFLEX SD



ISO-CONNECT VARIOFLEX SD+

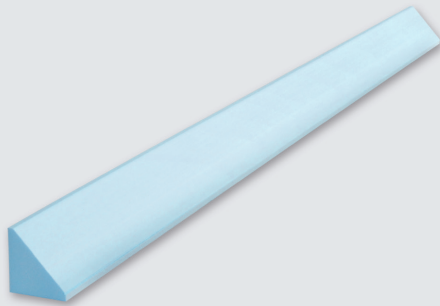

ISO-TOP RAIN PROTECTION PROFILE

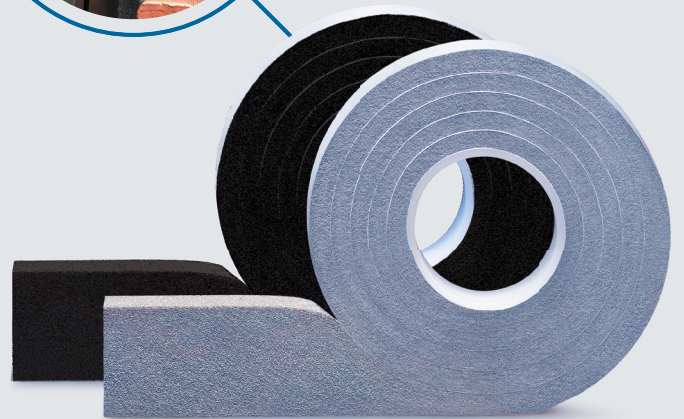

ISO-BLOCO 600 „MAXIBOND EDITION“



ISO-BLOCO 600 MAXIBOND EDITION

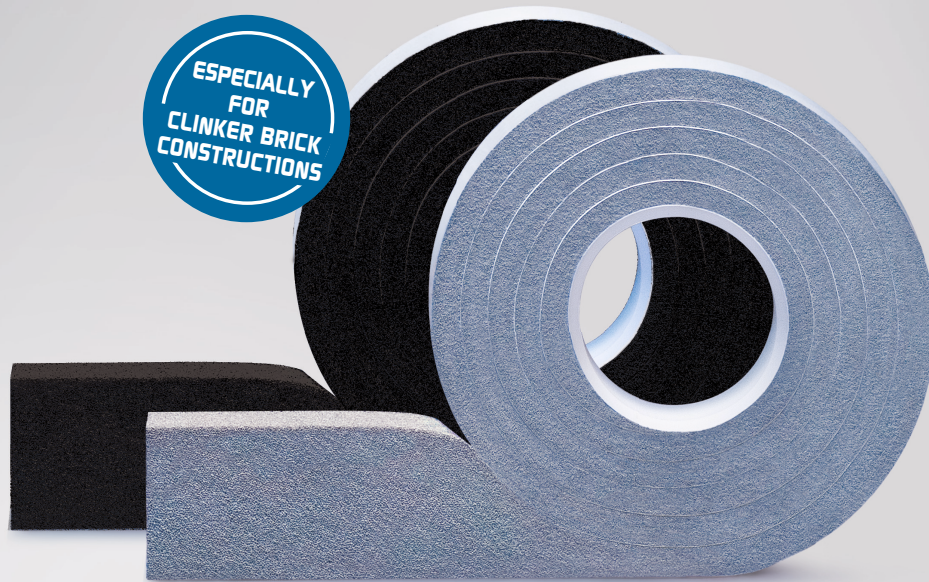

PRODUCT DESCRIPTION

ISO-BLOCO 600 „MAXIBOND EDITION“ is an impregnated PUR sealing tape with very high adhesive strength which offers very good initial adhesion, even on difficult substrates such as clinker or brick. The high elasticity allows the tape to cling perfectly to the joint faces on both sides. As a quality-tested BG 1 joint sealing tape, it meets the demanding requirements of DIN 18542, 2020 edition. As well as having a driving rain impermeability of more than 600Pa (corresponding to wind force 11), ISO-BLOCO 600 „MAXIBOND EDITION“ also offers outstanding sound and thermal insulation properties.

APPLICATION

A versatile product that has a wide range of uses, but generally for sealing construction joints (including moving joints) in areas such as between prefabricated concrete, skylights, cladding panels, curtain walling and perimeter seals for fenestration (windows/doors). Used in a variety of construction methods and industries including, general construction & civil engineering, steel and/or timber framed buildings and modular construction.

PRODUCT ADVANTAGES

- Very high adhesive strength for installation, even on substrates such as clinker and brick
- Time-saving installation, regardless of the weather conditions
- Long continuous lengths for increased ease of installation and fewer tape joints
- Meets the requirements of DIN 18542:2009 BG 1
- Seals reliably against driving rain, wind, dust and splashwater
- Safety thanks to wide area of application for joints
- Vapour diffusion permeable
- Permanently elastic with long term life expectancy
- Can be painted over using standard emulsion paints
- Can be used in all areas of construction and building types
- Constant quality to DIN standards
- Complies with the requirements of the German Building Energy Act and for RAL quality-assured installation



Technical data	Standard	Classification according to DIN 18542
Material description		impregnated PUR soft foam
Base		flame-retardant polymer dispersion
Colour		black, grey
Building material class	DIN 4102-1	B1 (hardly flammable)
Air permeability coefficient if externally supervised	DIN EN 12114	$\alpha < 1.0 \text{ m}^3 / [\text{h} \cdot \text{m} \cdot (\text{daPa})^{2/3}]$
Impermeable to driving rain, if externally supervised	DIN EN 1027	$\geq 600 \text{ Pa}$
Temperature stability range	DIN 18542	-30 °C to +90 °C
UV light and weather stability	DIN 18542	Requirements fulfilled
Compatibility with adjacent building materials	DIN 18542	Requirements fulfilled
Dimension tolerance	DIN 7715 T5 P3	Requirements fulfilled
Thermal conductivity	DIN EN 12667	$\lambda = 0.043 \text{ W/m} \cdot \text{K}$
sd-value	DIN EN ISO 12572	$\leq 0.5 \text{ m}$ at 50 mm width (open to vapour diffusion)
Shelf life		2 years, stored dry and in original packaging
Storage temperature		+1 °C to +20 °C

Tape width / area of application	Recommended joint width** BG 1	Roll (metres)	Rolls / Carton	Carton (metres)
15 / 6 – 15 mm	6 – 15 mm	4,3	20	86,0
20 / 9 – 20 mm	9 – 20 mm	6,6	15	99,0

** Movement in structural elements and temporary longitude changes are to be taken into account by the max. joint width.
If you have any questions about the areas of the application, please send an e-mail to: technik@iso-chemie.de



Einbaubeispiel: ISO-BLOCO 600 „MAXIBOND“

ISO-CONNECT VARIOFLEX SD

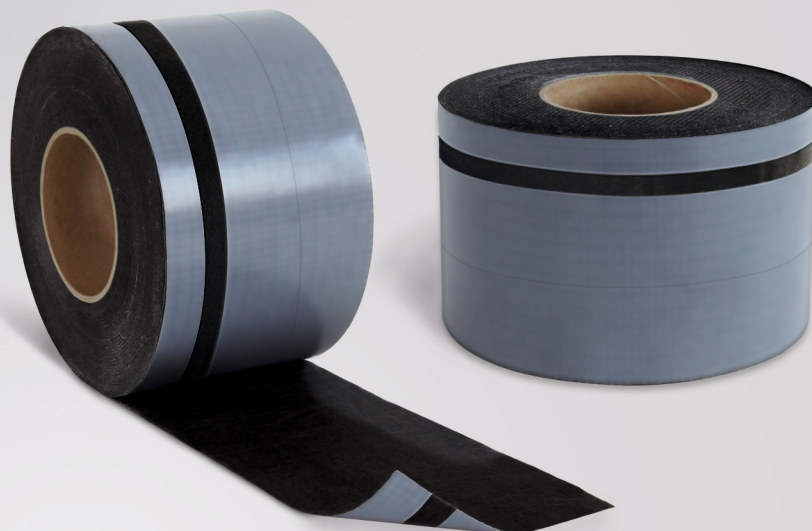

PRODUCT DESCRIPTION

ISO-CONNECT VARIOFLEX SD is a moisture-regulating film that can be used to seal connecting joints on windows, doors and panels. The moisture-viable special film adapts its sd value to the different temperature gradients from the inside to the outside or from the outside to the inside. The liner of ISO-CONNECT VARIOFLEX SD is particularly easy to remove thanks to the narrow, adhesive-free surface.

APPLICATION

ISO-CONNECT VARIOFLEX SD is suitable for sealing connecting joints in doors and windows both indoors and outdoors. The self-adhesive variants COMPLETE F and COMPLETE F DUO have the advantage that no additional bonding is required. is necessary.

DIMENSIONS

Widths versions COMPLETE F/COMPLETE F DUO:
70, 90, 140, 190 mm

PACKAGING

Supplied on rolls, roll length: 30 m

PRODUCT ADVANTAGES

- high stretchability and flexible adaptation
- variable sd value, can be used inside and out
- low inherent rigidity combined with high tensile strength for simple and precise application
- airtight and windproof
- resistant to driving rain and impermeable to water
- special fleece surface which is easy to plaster, paint or glue
- with self-adhesive strip for quick and effective fitting
- complies with the requirements of the Building Energy Act and the recommendations of the RAL "installation guide"
- 10 Year Function Warranty*

* On the conditions of the manufacturer (available on request).

Versions

COMPLETE F	
COMPLETE F DUO	

All COMPLETE-variants with 2-way or 3-way split liner.

Foil Self-adhesive strip





Technical data: Foil	Standard	Classification
Material description		polymer fleece that is permeable to vapour diffusion
Colour		black
Resistance of joints to driving rain	DIN EN 1027	$\geq 1,050\text{Pa}$
Joint permeability coefficient	DIN EN 12114	airtight $a \leq 0.1 \text{ m}^3/[\text{h}\cdot\text{m}\cdot(\text{daPa})^{2/3}]$
UV stability		approx. 8 months
Temperature resistance	internal	-40°C to $+90^\circ\text{C}$
sd value	DIN EN ISO 12572	0.4 to 25 m depending on the moisture levels
Pliability at -23°C	internal	no breakage, no cracking
Fire behaviour	DIN EN 13501	E
Dimensional tolerance	DIN 7715 T5 P3	requirements fulfilled
Storage time		1 year, in original packaging and stored dry
Storage temperature		$+1^\circ\text{C}$ to $+20^\circ\text{C}$

SERVICE

- fast standard delivery from stock
- knowledgeable commercial and technical advice
- advice on installation and on-site instruction

PROCESSING

The substrate for the surfaces to be bonded must be sound and solid. Remove all dust, release agents, oil or grease, and any moisture or ice. Remove the backing paper from the self-adhesive strip when sealing house door and window connections or panels. Then apply the foil to the frame and press down hard or roll with a roller. The foil can then be applied to the mural and rolled on. ISO-CONNECT VARIOFLEX SD can be pre-fitted in the workshop. Full-surface bonding must be achieved in the area to be plastered over. Due to the one-sided self-adhesion, no additional bonding with an MS polymer adhesive is required. Foil overlaps should be $> 50\text{mm}$ wide. Plastering can start as soon as the adhesive has dried enough for the foil to bear the weight of the plaster. As there are so many external influences and surface finishes, always test a small sample before use to determine the adhesive properties. Adhesive repairs or separated areas can be reglued with ISO-TOP FLEX-ADHESIVE XP.

ISO-CONNECT VARIOFLEX SD+

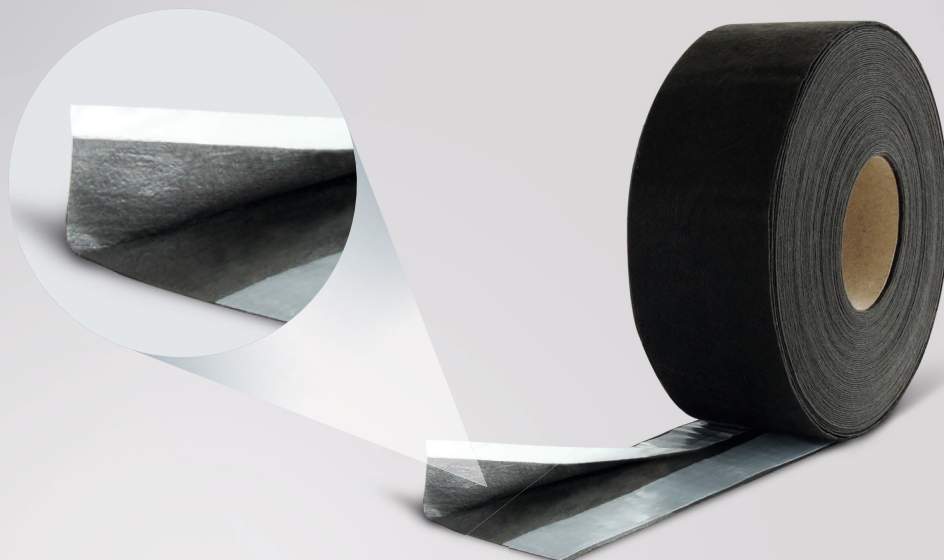

PRODUCT DESCRIPTION

ISO-CONNECT VARIOFLEX SD+ is a highly flexible and stretchy special foil that can be used for connection joints for windows, doors and panels to create a seal that is airtight and windproof. ISO-CONNECT VARIOFLEX SD+ consists of a flexible soft plastic fleece and has very good adhesive properties. When the fold is closed of the fold (20 mm), the foil is used as the COMPLETE F with adhesive strips applied to one side. By opening the fold (20 mm), the COMPLETE F DUO with self-adhesive strips on both sides. A single foil can thus be used for all sealing applications between window frame and building structure.

APPLICATION

ISO-CONNECT VARIOFLEX SD+ is used in the interior and exterior of buildings for bonding over window connection joints; with its variable sd-value, it is particularly adaptable to the substrate. The principle of "tighter on the inside than on the outside" is therefore guaranteed at all times and in any climate. The foil creates a reliable seal for movement joints. As it is extremely good for absorbing movement whilst offering high tensile strength, it can compensate even for significant component movements.

PRODUCT ADVANTAGES

- fold technology for universal usability
- high stretchability and flexible adaptation
- variable sd value, can be used inside and out
- low inherent rigidity combined with high tensile strength for simple and precise application
- airtight and windproof
- resistant to driving rain and impermeable to water
- special fleece surface which is easy to plaster, paint or glue
- with self-adhesive strip for quick and effective fitting
- complies with the requirements of the Building Energy Act (EnEV was valid 31.10.20) and the recommendations of the RAL "installation guide"
- 10 Year Function Warranty*

* On the conditions of the manufacturer (available on request).

VERSIONS

By opening the 20 mm longitudinal fold, the variant COMPLETE F with self-adhesive on one side becomes the COMPLETE F DUO with alternating adhesive surfaces.



Technical data: Foil	Standard	Classification
Material description		polymer fleece that is permeable to vapour diffusion
Colour		black
Resistance of joints to driving rain	DIN EN 1027	$\geq 1,050\text{Pa}$
Joint permeability coefficient	DIN EN 12114	airtight $a \leq 0.1 \text{ m}^3/[\text{h}\cdot\text{m}\cdot(\text{daPa})^{2/3}]$
UV stability		approx. 8 months
Temperature resistance	internal	-40°C to +90°C
sd value	DIN EN ISO 12572	0.4 to 25 m depending on the moisture levels
Pliability at -23°C	internal	no breakage, no cracking
Fire behaviour	DIN EN 13501	E
Dimensional tolerance	DIN 7715 T5 P3	requirements fulfilled
Storage time		1 year, in original packaging and stored dry
Storage temperature		+1°C to +20°C

DIMENSIONS

Folded foil in working widths:

- 85 mm (folded 65+20 mm)
- 100 mm (folded 80+20 mm)
- 150 mm (folded 130+20 mm)
- 200 mm (folded 180+20 mm)

all with a 20 mm fold-out foil part.

Other dimensions available upon request.

PACKAGING

Supplied on rolls, roll length: 30 m

SERVICE

- fast standard delivery from stock
- knowledgeable commercial and technical advice
- advice on installation and on-site instruction

PROCESSING

The substrate for the surfaces to be bonded must be sound and solid. Remove all dust, release agents, oil or grease, and any moisture or ice. Remove the backing paper from the self-adhesive strip when sealing house door and window connections or panels. Then apply the foil to the frame and press down hard or roll with a roller. Then open the fold; the foil can now be stuck to the walls and rolled. ISO-CONNECT VARIOFLEX SD+ can be pre-fitted in the workshop. The folded shape allows the foil to lie flat and smooth against the frame; it is not unfolded until it is used on site. Full-surface bonding must be achieved in the area to be plastered over. Due to the one-sided self-adhesion in the folded state, no additional bonding with an MS polymer adhesive is required. Foil overlaps should be > 50 mm wide. Plastering can start as soon as the adhesive has dried enough for the foil to bear the weight of the plaster. As there are so many external influences and surface finishes, always test a small sample before use to determine the adhesive properties. Adhesive repairs or separated areas can be reglued with ISO-TOP FLEX-ADHESIVE XP.

ISO-TOP RAIN PROTECTION PROFILE

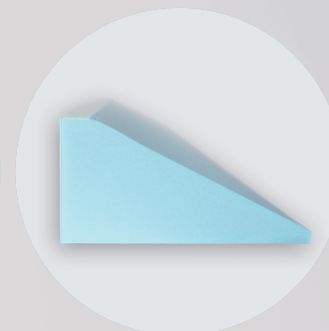
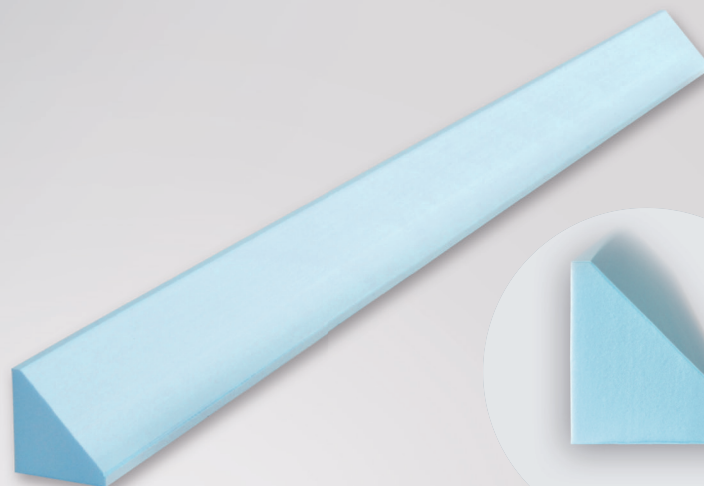

PRODUCT DESCRIPTION

The ISO-TOP RAIN PROTECTION PROFILE made from high-grade, compression-resistant XPS was specially developed for in-front-of-wall installation systems. It reliably deflects water at the upper horizontal connection between components. The ISO-TOP RAIN PROTECTION PROFILE guarantees functionally reliable deflection of water running down, both during the critical shell construction phase and throughout the entire useful life of the building. In combination with suitable foils, the ISO-TOP RAIN PROTECTION PROFILE effectively prevents the uncontrolled penetration of water into the structure. This is particularly important during the shell construction phase when large amounts of water can run down the surface of the facade. The well thought-out design allows the wedge to reliably direct the water in front of window systems, thus preventing water collecting and backing up. With its high-precision shaping and high-quality material, it guarantees long-term and reliable sealing that substantially helps to maintain the state of the building.

APPLICATION

The ISO-TOP RAIN PROTECTION PROFILE is used in double-leaf and multi-leaf facade constructions. It is fitted to the upper horizontal connection of overhanging constructions where it can perform its protective function to best effect. Specially designed for use in in-front-of-wall installations, the ISO-TOP RAIN PROTECTION PROFILE is excellent for deflecting rainwater. It reliably deflects the water away from the component, offering effective protection for the facade against unwanted water ingress.

PRODUCT ADVANTAGES

- excellent functional weather protection
- prevents unwanted collection and backing up of water
- perfect for ISO-TOP WINFRAMER & overhanging components
- simple to cut to length
- excellent for new builds and renovations to reduce energy consumption
- suitable for passive energy houses
- complies with the requirements of the Building Energy Act and the recommendations of the RAL "installation guide"
- 10-year functional warranty*

* On the conditions of the manufacturer (available on request).

ACCESSORIES

- ISO-TOP FLEX-ADHESIVE WF for bonding to ISO-TOP WINFRAMER wood profiles and wall surfaces
- ISO-CONNECT OUTSIDE CL as temporary weather protection until it is definitively covered over with a thermal insulation composite system
- ISO-CONNECT OUTSIDE EPDM as permanent mechanical weather protection for rear-ventilated, lightweight and heavy wall shells such as clinker bricks, metal facades and stone cladding panels

Technical data	Standard	Classification
Material description		XPS polystyrene
Colour		light blue
Density	DIN EN 1602	33 kg/m ³
Building material class	DIN EN 13501-1	E
Thermal conductivity	DIN EN 13164	$\lambda = 0,033 - 0,035 \text{ W}/(\text{m} \cdot \text{K})$
Compression stress/compression strength at 10% compression*	DIN EN 826	300 kPa \pm 0,3 N/mm ²
Long-term creep characteristics (50 years) at 2% compression	DIN EN 1606	130 kPa \pm 0,13 N/mm ²
Elasticity module	DIN EN 826	< 50 mm = 12.000 kPa / \geq 50 mm = 20.000 kPa
Long-term water absorption by immersion	DIN EN 12087	0,7 Vol. %
Water absorption by diffusion	DIN EN 12088	< 50 mm = 3 Vol. % 50 – 79 mm = 2 Vol. % \geq 80 mm = 1 Vol. %
Water absorption after freeze-thaw cycling	DIN EN 12091	1 Vol. %
Dimensional stability under defined temperature (70 °C) and humidity (90%) conditions	DIN EN 1604	< 5%
Deformation under specified compressive (40 kPa) and temperature (7 °C) stress		< 5
Linear thermal expansion coefficient		0,07 mm/(m · K)
Dimensional tolerance	DIN 7715 T5 P3	requirements fulfilled
Waste code		170604, 170904
Shelf life		24 months

PROCESSING

The ISO-TOP RAIN PROTECTION PROFILE is placed directly on the ISO-TOP WINFRAMER "TYPE 1" or "TYPE 3" and is then bonded continuously to the wall and to the WINFRAMER system using ISO-TOP FLEX-ADHESIVE WF. Depending on requirements, the ISO-TOP RAIN PROTECTION PROFILE can then be covered with an ISO-CONNECT sealing foil or the ISO-CONNECT OUTSIDE EPDM foil.

PACKAGING

- Precut in 1200 mm lengths

DIMENSION

Designation	Length (mm)	Width (mm)	Height (mm)	Suitable for all ISO-TOP WINFRAMER systems
Rain protection profile 70	1200	70	70	1200x70x70
Rain protection profile 80	1200	80	80	1200x80x80
Rain protection profile 90	1200	90	90	1200x90x80
Rain protection profile 100	1200	100	100	1200x100x80
Rain protection profile 120	1200	120	120	1200x120x80
Rain protection profile 140	1200	140	140	1200x140x80 / 1200x140x90
Rain protection profile 150	1200	150	150	1200x150x110
Rain protection profile 160	1200	160	160	1200x160x80 / 1200x160x110
Rain protection profile 170	1200	170	170	1200x170x110
Rain protection profile 180	1200	180	180	1200x180x80 / 1200x180x110
Rain protection profile 200	1200	200	200	1200x200x80 / 1200x200x110
Rain protection profile PREFAB	1200	Custom-made as per drawing	Custom-made as per drawing	1200xdesired dimensionxdesired dimension

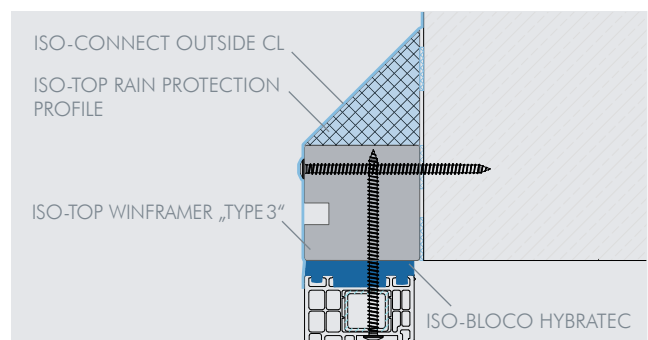

Installation example: ISO-TOP WETTERSCHUTZKEIL

THE NEW GREEN IS BLUE – USE THE BLUE TECHNOLOGY.

The subject of energy saving is more relevant than ever. We are committed to developing new contemporary ideas, offering solutions and triggering innovations. We have been concentrating on the development of energy-efficient and sustainable sealing solutions particularly in the field of building sealing ever since the company was founded. This motivation has led to the launch of a series of environmentally friendly products for the sealing of window, metal, wood and façade constructions, as well as fire protection and external thermal insulation composite systems, all of which contribute to reducing the energy consumption on our blue planet.

As a further statement of the sustainability of our products, we have drawn up environmental product declarations (EPDs) for many of our sealing systems. The EPDs for our polyurethane and polyethylene sealing tapes and our pre-wall installation systems or façade and window connection foils provide a comprehensive overview of all the environmental impacts associated with product manufacture. In addition to quantified environmental information from the life cycle of the products, the EPDs also show that the products are extremely energy-efficient and that their use has a positive impact on energy consumption and therefore on the life cycle assessment of buildings.



Even after more than 45 years, we at ISO-Chemie still find the subject of foam technology fascinating and are dedicated with our natural curiosity, creativity and enjoyment of our daily work to developing environmentally friendly and energy-efficient products – for a more comfortable present and a better future.

CLASSIFICATION FOR LOW EMISSION PRODUCTS

Many of our sealing products are rated as “very low-emission” with the GEV mark EMI CODE® EC1 PLUS. This premium classification by the Association for the Control of Emissions in Products for Flooring Installation, Adhesives and Building Materials e.V. (GEV) means maximum possible protection against ambient air contamination. As a result, both users and clients can be sure that these products do not give off hazardous substances into the ambient air and do not represent any risk to health.



illustration purposes only



ENVIRONMENT CERTIFICATION ACCORDING TO ISO 14001

We constantly work to further extend our company’s environmental activities. One outward sign of our commitment is certification to the ISO 14001 international environmental management standard.

This internationally recognised environmental management system is based on voluntary measures implemented by the company to protect the environment and contribute to a continuous improvement process. For this, we have defined measurable environmental targets, such as waste disposal measures, a further lowering of energy consumption and a reduction of CO₂ emissions through the use of photovoltaic technology to generate energy. Other important targets include the sparing use of resources by working with environmentally-friendly, non-harmful, recyclable materials and minimising our use of water, electricity and raw materials.

So we have aligned our environmental policy towards achieving these demanding targets, whilst complying with the applicable statutory obligations. Our environmental management system is regularly checked by an external body to ensure that we continue to improve.

SUSTAINABLE SEALING WITH ISO-CHEMIE!

MANY OF OUR PRODUCTS ARE
LISTED IN THE DGNB NAVIGATOR.



ISO
CHEMIE
Use the blue technology.

ISO-Chemie GmbH
Röntgenstraße 12
73431 Aalen, Germany

Deutschland
Tel.: +49 (0)7361 94 90-0
Fax: +49 (0)7361 94 90-90
info@iso-chemie.de
www.iso-chemie.de

Spanien und Portugal
Tel.: +34 (0)911 98 50 53
Fax: +34 (0)911 98 50 54
info@iso-chemie.es
www.iso-chemie.es

Frankreich
Tel.: +33 (0)4 78 34 89 75
Fax: +33 (0)4 78 34 87 72
info@iso-chemie.fr
www.iso-chemie.fr

Polen
Tel.: +48 71 88 10 048
Fax: +48 71 88 10 049
info@iso-chemie.pl
www.iso-chemie.pl

Großbritannien
Tel.: +44 (0)1207 56 68 67
Fax: +44 (0)1207 56 68 69
info@iso-chemie.co.uk
www.iso-chemie.co.uk

Slowenien
Tel.: +49 (0)7361 94 90-8385
Fax: +49 (0)7361 94 90 93
info@iso-chemie.eu
www.iso-chemie.eu

Italien
Tel.: +39 02947 56 159
Fax: +39 02947 56 160
info@iso-chemie.it
www.iso-chemie.it

Finnland
Tel.: +358 94 24 50 462
Fax: +358 94 24 50 751
info@iso-chemie.fi
www.iso-chemie.fi