

PRODUCT DATA SHEET

ISO-TOP RAIN PROTECTION PROFILE

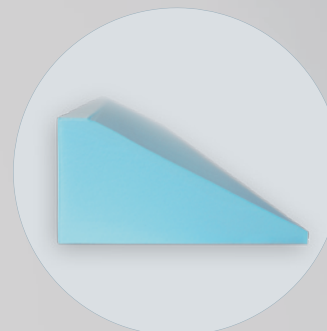
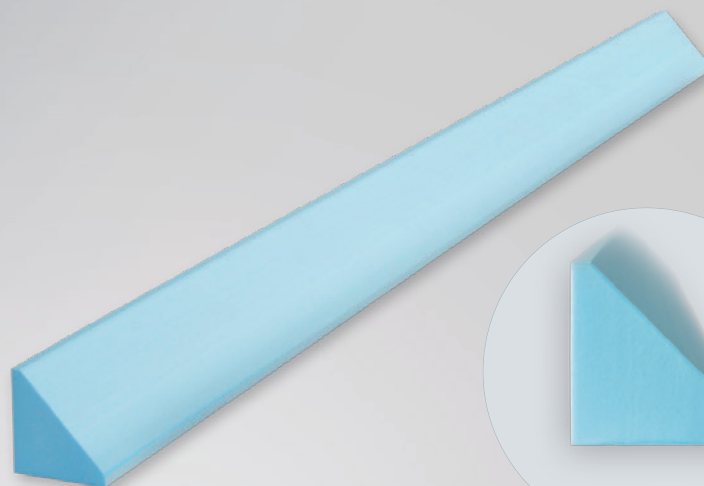

PRODUCT DESCRIPTION

The ISO-TOP RAIN PROTECTION PROFILE made from high-grade, compression-resistant XPS was specially developed for in-front-of-wall installation systems. It reliably deflects water at the upper horizontal connection between components. The ISO-TOP RAIN PROTECTION PROFILE guarantees functionally reliable deflection of water running down, both during the critical shell construction phase and throughout the entire useful life of the building. In combination with suitable foils, the ISO-TOP RAIN PROTECTION PROFILE effectively prevents the uncontrolled penetration of water into the structure. This is particularly important during the shell construction phase when large amounts of water can run down the surface of the facade. The well thought-out design allows the wedge to reliably direct the water in front of window systems, thus preventing water collecting and backing up. With its high-precision shaping and high-quality material, it guarantees long-term and reliable sealing that substantially helps to maintain the state of the building.

APPLICATION

The ISO-TOP RAIN PROTECTION PROFILE is used in double-leaf and multi-leaf facade constructions. It is fitted to the upper horizontal connection of overhanging constructions where it can perform its protective function to best effect. Specially designed for use in in-front-of-wall installations, the ISO-TOP RAIN PROTECTION PROFILE is excellent for deflecting rainwater. It reliably deflects the water away from the component, offering effective protection for the facade against unwanted water ingress.

PRODUCT ADVANTAGES

- excellent functional weather protection
- prevents unwanted collection and backing up of water
- perfect for ISO-TOP WINFRAMER & overhanging components
- simple to cut to length
- excellent for new builds and renovations to reduce energy consumption
- suitable for passive energy houses
- complies with the requirements of the Building Energy Act and the recommendations of the RAL "installation guide"
- 10-year functional warranty*

* On the conditions of the manufacturer (available on request).

ACCESSORIES

- ISO-TOP FLEX-ADHESIVE WF for bonding to ISO-TOP WINFRAMER wood profiles and wall surfaces
- ISO-CONNECT OUTSIDE CL as temporary weather protection until it is definitively covered over with a thermal insulation composite system
- ISO-CONNECT OUTSIDE EPDM as permanent mechanical weather protection for rear-ventilated, lightweight and heavy wall shells such as clinker bricks, metal facades and stone cladding panels

ISO-TOP RAIN PROTECTION PROFILE

Technical data	Standard	Classification
Material description		XPS polystyrene
Colour		light blue
Density	DIN EN 1602	33 kg/m ³
Building material class	DIN EN 13501-1	E
Thermal conductivity	DIN EN 13164	$\lambda = 0,033 - 0,035 \text{ W}/(\text{m} \cdot \text{K})$
Compression stress/compression strength at 10% compression*	DIN EN 826	300 kPa \pm 0,3 N/mm ²
Long-term creep characteristics (50 years) at 2% compression	DIN EN 1606	130 kPa \pm 0,13 N/mm ²
Elasticity module	DIN EN 826	< 50 mm = 12.000 kPa / \geq 50 mm = 20.000 kPa
Long-term water absorption by immersion	DIN EN 12087	0,7 Vol. %
Water absorption by diffusion	DIN EN 12088	< 50 mm = 3 Vol. % 50 – 79 mm = 2 Vol. % \geq 80 mm = 1 Vol. %
Water absorption after freeze-thaw cycling	DIN EN 12091	1 Vol. %
Dimensional stability under defined temperature (70 °C) and humidity (90%) conditions	DIN EN 1604	< 5%
Deformation under specified compressive (40 kPa) and temperature (7 °C) stress		< 5
Linear thermal expansion coefficient		0,07 mm/(m · K)
Dimensional tolerance	DIN 7715 T5 P3	requirements fulfilled
Waste code		170604, 170904
Shelf life		24 months

PROCESSING

The ISO-TOP RAIN PROTECTION PROFILE is placed directly on the ISO-TOP WINFRAMER "TYPE 1" or "TYPE 3" and is then bonded continuously to the wall and to the WINFRAMER system using ISO-TOP FLEX-ADHESIVE WF. Depending on requirements, the ISO-TOP RAIN PROTECTION PROFILE can then be covered with an ISO-CONNECT sealing foil or the ISO-CONNECT OUTSIDE EPDM foil.

PACKAGING

- Precut in 1200 mm lengths

DIMENSION

Designation	Length (mm)	Width (mm)	Height (mm)	Suitable for all ISO-TOP WINFRAMER systems
Rain protection profile 70	1200	70	70	1200x70x70
Rain protection profile 80	1200	80	80	1200x80x80
Rain protection profile 90	1200	90	90	1200x90x80
Rain protection profile 100	1200	100	100	1200x100x80
Rain protection profile 120	1200	120	120	1200x120x80
Rain protection profile 140	1200	140	140	1200x140x80 / 1200x140x90
Rain protection profile 150	1200	150	150	1200x150x110
Rain protection profile 160	1200	160	160	1200x160x80 / 1200x160x110
Rain protection profile 170	1200	170	170	1200x170x110
Rain protection profile 180	1200	180	180	1200x180x80 / 1200x180x110
Rain protection profile 200	1200	200	200	1200x200x80 / 1200x200x110
Rain protection profile PREFAB	1200	Custom-made as per drawing	Custom-made as per drawing	1200xdesired dimensionxdesired dimension

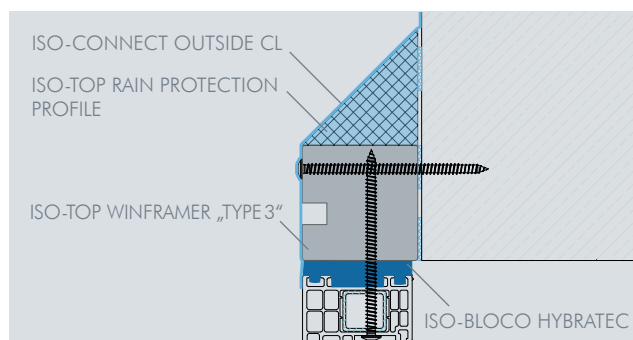

Installation example: ISO-TOP RAIN PROTECTION PROFILE

The details and information given in this literature are based on best current knowledge. They are intended to serve as general information only and it is advised that the user conducts their own tests for their specific set of conditions to determine the suitability of the product for its proposed use. No warranty or liability is given or implied regarding any part of these instructions or details, or the completeness of the information. We reserve the right to modify, or change, the specifications and information without advance notification. All goods are supplied subject to our standard conditions of sales, copies of which are available upon request.