

PRODUCT DATA SHEET

ISO-CONNECT OUTSIDE EPDM

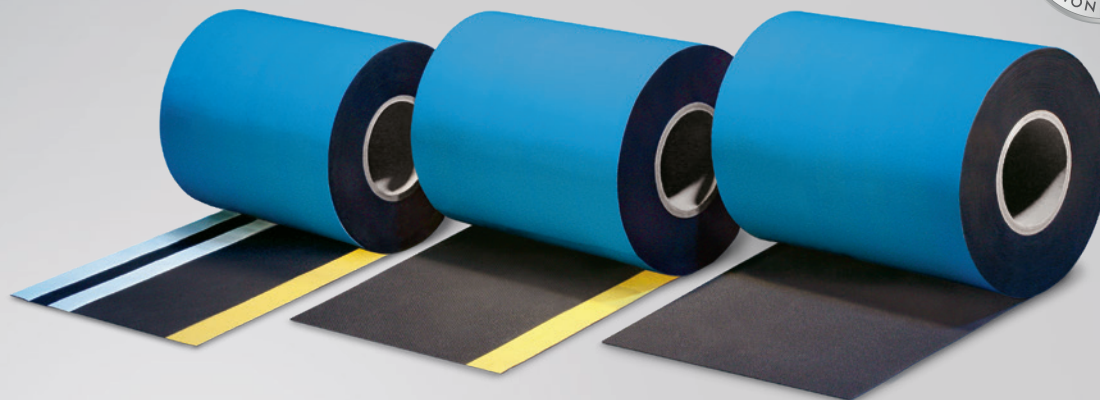

PRODUCT DESCRIPTION

ISO-CONNECT OUTSIDE EPDM is an elastomeric sealing band which serves as an external sealant on windows and facades in accordance with DIN 18531 and DIN 18533. ISO-CONNECT OUTSIDE EPDM is particularly suitable for external facade and window sealing projects. It has a thickness of ≥ 1.1 mm and conforms with the DIN-requirements.

APPLICATION

ISO-CONNECT OUTSIDE EPDM is a special outer sealant, designed in accordance with DIN 18195, for building structures and used as the complete perimeter seal and / or the base seal for doorways and floor fitting windows. In addition it is exceptionally suitable for the external sealing of structural building facades, making ISO-CONNECT OUTSIDE EPDM a versatile and proven sealing product compatible with all major building materials.

FINISHES

- Finish A: without self-adhesive
- Finish B: SK
single side self-adhesive with 1 self-adhesive strip
- Finish C: BT
single side self-adhesive with 1 or 2 butyl-adhesive strips, subject to product width
- Finish D: SK-BT
single side self-adhesive with 1 self-adhesive strip and 1 or 2 butyl-adhesive strips, subject to product width

PRODUCT ADVANTAGES

- permanent outer sealant
- high elasticity – compensates for joint movement
- extreme temperature and weather resistant
- bitumen compatible
- complies with the requirements of the Building Energy Act (EnEV was valid 31.10.20) and the recommendations of the RAL “installation guide”
- 10 Year Function Warranty*

* On the conditions of the manufacturer (available on request).

DIMENSIONS

width: 100, 150, 200, 250, 300, 400, 500 mm
alternative dimensions available on request

PACKAGING

rolls, roll length: 25 m

PREPARATION

Unroll ISO-CONNECT OUTSIDE EPDM elastomer sealing band and cut to the required length. The surface must be clean, dry and free from solvents, grease, dust, oil and other anti-adhesive substances.



ISO-CONNECT OUTSIDE EPDM

Technical data	Standard	Classification
Material description		synthetic caoutchouc on EPDM basis
Colour		black
Building material class	DIN EN 13501	E
Impermeable to driving rain	DIN EN 1027	≥ 1,050 Pa
Bitumen compatible	DIN 7864 T1	bitumen compatible
UV stability	DIN 7864 T1	UV resistant
sd-value	DIN EN ISO 12572	0.8 mm approx. 25.6 m / 1.2 mm approx. 38.4 m
Ozone resistance	DIN 7864 T1	ozone resistant
Water vapour diffusion resistance μ	DIN EN 1931	≈ 32,000
Material thickness		0.8 mm and 1.2 mm
Elongation at break	DIN 53504	≥ 300 %
Tensile strength	DIN 53504	≥ 6.5 mPa
Maximum tear resistance	DIN 53504	≥ 25 kN/m
Temperature stability range		-30 °C to +100 °C
Handling temperature		+5 °C to +35 °C
Dimension tolerance	DIN 7715 T5 P3	requirements fulfilled
Storage temperature		+1 °C to +25 °C
Shelf life		unlimited (EPDM), finishes with adhesive strips 12 months, dry and in original packing

DIRECTIONS FOR USE

To generate an air tight seal, bond one edge of the band with a gunnable solvent free adhesive such as ISO-TOP FLEX-ADHESIVE XP and fix the other edge with mechanical fixings, e. g. clamps or components of the window system as described in DIN 18531 and DIN 18533. Alternatively, finish B and D are supplied with an acrylic adhesive strip to assist attaching the end to the aluminium window until the mechanical fixings are installed, or a gunned adhesive is applied. When using finishes with butyl-adhesive, pre-treat any porous and absorbent surfaces with ISO-TOP BLUE PRIMER and then apply the self-adhesive material to the surface. For all adhesive areas use a roller to carefully apply pressure to the area until the product adopts the contours of the facade. Butyl caoutchouc adhesives are sensitive to solvents. When bonding the complete surface, using a solvent based contact adhesive, coat both the band and the substrate and then carefully press into place.

ISO-CONNECT EPDM SEALING CORNERS

To supplement ISO-CONNECT OUTSIDE EPDM, we also supply moulded EPDM sealing corners for various connection areas on buildings. These can be used for in front of wall elements, for the lower connection area, on floor-level elements, balcony doors and patio door systems. For further information, see datasheet of ISO-CONNECT EPDM SEALING COLLAR AND SEALING CORNER.

DIMENSIONS SEALING CORNERS

inside corner: 100 x 100 x 100 mm (thickness 0.75 and 1.2 mm)
outside corner: 200 x 200 x 100 mm (thickness 0.75 and 1.2 mm)

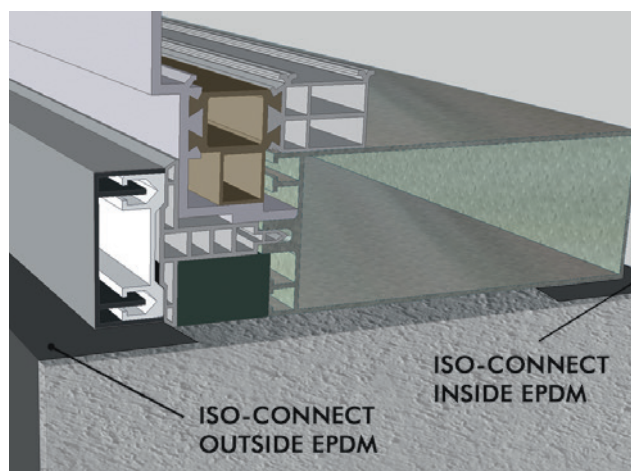

Installation example: ISO³-WINDOW SEALING SYSTEM

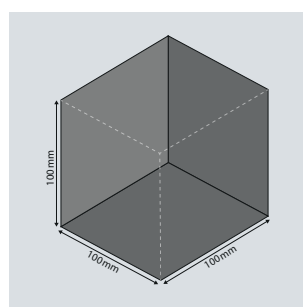

inside corner

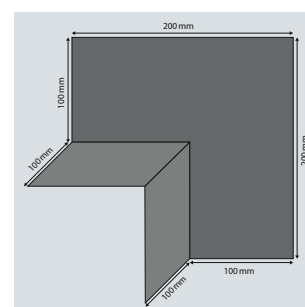

outside corner

The details and information given in this literature are based on best current knowledge. They are intended to serve as general information only and it is advised that the user conducts their own tests for their specific set of conditions to determine the suitability of the product for its proposed use. No warranty or liability is given or implied regarding any part of these instructions or details, or the completeness of the information. We reserve the right to modify, or change, the specifications and information without advance notification. All goods are supplied subject to our standard conditions of sales, copies of which are available upon request.