

INSTALLATION INSTRUCTIONS

ISO-BLOCO RENO



Multifunctional sealing and insulating system
specially developed for energy-related window renovation



Scan here to view
construction site
video:



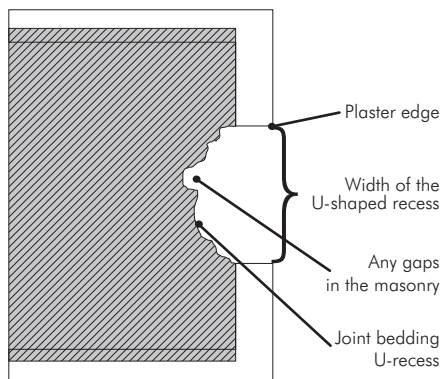
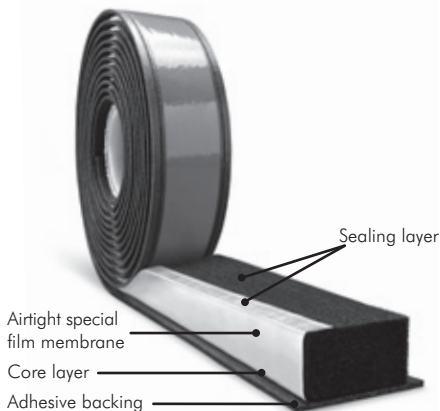

TOOLS

- Tape measure or metre rule
- Scissors or knife

1. Removal of the old window

Use a masonry router or electric jack saw to remove the old window.

You will need parallel and stable plaster edges in order to use ISO BLOCO RENO. Remove all traces of the old window from the joint.

There are various adapter foams and filler materials available for filling gaps in the masonry (see the Adapter foams section).

2. Measure the width of the U-shaped recess and select the right tape.

- Determine the right type of tape for the width of the U-shaped recess (see table).
- Select the tape size to suit the window

frame installation depth and the recommended joint application range (see table).

- Determine how much tape you will need by measuring the individual sides of the window frame.

The ISO BLOCO RENO special film membrane must be fitted on the room side. Once you have fitted the ISO BLOCO RENO, the sealing system starts to slowly expand, and seals the gap between the core layer and the side of the window frame. The seal is functionally reliable and long-lasting.

EXPANSION TIMES AND STORAGE

As we know, heat accelerates and cold delays expansion. It is not only the temperature of the surrounding air and substrate that affect this, but also the temperature of the sealing tape itself. For this reason, the product should always be

Tape width x Area of application	Width U-shaped recess	Area of application sealing level*	
		BG 1	BG 2
65 / 6 – 20 mm	48 – 64 mm	6 – 20 mm	6 – 27 mm
75 / 6 – 20 mm	58 – 74 mm		
85 / 6 – 20 mm	68 – 84 mm		
95 / 6 – 20 mm	78 – 94 mm		
65 / 8 – 33 mm	48 – 64 mm	8 – 33 mm	8 – 43 mm
75 / 8 – 33 mm	58 – 74 mm		
85 / 8 – 33 mm	68 – 84 mm		
95 / 8 – 33 mm	78 – 94 mm		

* Other dimensions available upon request.

* Movement of the components and temporary changes of length of the existing joints should be taken into account when determining the right tape size. U-shaped recess depths that exceed these areas of application can be reduced using suitable insulation materials.

stored under normal room conditions. The product is designed to allow sufficient time for the individual fitting process.

ADAPTER MATERIALS

Depending on the masonry, the joint base may be fairly flat, or there may be large pieces missing from the old masonry. If there are large pieces missing, they must first be filled with an adapter material. It is sufficient to pack them out to 15 mm below the plaster surface of the window reveal. Suitable adapter materials include:

- ISO-BLOCO HF
- Closed-cell PU foam tapes
- Impregnated, compressed PU foam
- Mineral wool
- Glass fibre board
- Wood fibre board
- Expandable PU foam (residual foam can remain in the U-shaped recess after the visual inspection)

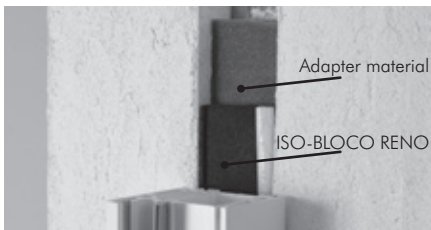

FITTING

1. Cut the leader tape at the start of the tape using scissors or a blade, and remove entirely. Tear off the leader tape from the core layer.

NOTE

After cutting the joint sealing tape to length, secure the start of the tape on the roll using self-adhesive tape, or screws.

2. Cut the start of the tape off straight and remove part of the release paper or the adhesive backing.

NOTE

Before attaching the joint sealing tape system, make sure that the special airtight film membrane is pointing inwards into the room.

3. Fold back the side flaps of the core layer slightly, remove the remaining adhesive backing cover film and fit the sticky side of the joint tape into the U-shaped recess so that the sticky side lies against the edges of the plaster. Press the tape into the U-shaped recess until it is positioned flush against the inner plaster edge. Pay particular attention to joint functional areas. Use adapter foam or suitable insulating materials to fill any U-shaped recesses > 15 mm deep before fitting ISO-BLOCO RENO.



CREATING THE CORNERS

The tape is fitted in one piece around in the corners. To shape the corner, crease the tape to form a sharp edge and guide it further into the U-shaped recess in the masonry.

CONNECTION AT THE BOTTOM

To create a seal underneath existing window sills, ISO BLOCO RENO can be cut into a narrower tape with a knife blade and placed in the bottom U-shaped recess.

NOTE

Sealing against standing water:

For the bottom external seal, we recommend that you use the ISO-CONNECT OUTSIDE or VARIO SD window connection film in combination with our ISO BLOCO 600 and ISO BLOCO HF sealing products.

In so doing, make sure that the window connection film is attached around the bottom corners of the window frame (at least 10 cm above the window sill height).

INSERTING WINDOW SCREWS

The hole can be drilled through the fitted, still compressed joint sealing tape. Make sure that the joint sealing tape is fixed in the U-shaped recess, where appropriate.



JOINING THE TAPE

Pieces of the joint sealing tape can be easily butted up against one another. Simply make sure that the joints fit precisely together. To do this, carefully cut them straight and butt the two ends of the tape for the sealing level up against one another with approximately 0.5 cm excess, by cutting the core layer back 5 mm on one end. The finishing layer is then cut around 5 mm shorter.

NOTE

Corner connections and tape splices can be sealed with acrylate adhesive/seam paste during fitting, if necessary.

VISUAL FINISH

The joints remaining between the window frames and plaster surfaces can be visually finished after fitting using cover tapes, extruded sealant or mineral based plaster.



The details and information given in this literature are based on best current knowledge. They are intended to serve as general information only and it is advised that the user conducts their own tests for their specific set of conditions to determine the suitability of the product for its proposed use. No warranty or liability is given or implied regarding any part of these instructions or details, or the completeness of the information. We reserve the right to modify, or change, the specifications and information without advance notification. All goods are supplied subject to our standard conditions of sales, copies of which are available upon request.